

P205 Series



General Specifications

Partnumber	Voltage (V)	Reduction (:1)	Length (mm)	Diameter (mm)	Nominal torque (mNm)	Speed at nominal torque	Current (A)
P205-12-4	12	4	120,5	42,0	500	625	5,45
P205-24-4	24	4	120,5	42,0	500	640	2,70
P205-12-6	12	6,25	120,5	42,0	600	459	4,20
P205-24-6	24	6,25	120,5	42,0	600	470	2,15
P205-12-16	12	16	133	42,0	1500	178	4,50
P205-24-16	24	16	133	42,0	1500	186	2,20
P205-12-25	12	25	133	42,0	2500	110	4,55
P205-24-25	24	25	133	42,0	2500	116	2,30
P205-12-39	12	39,06	133	42,0	3500	75	4,20
P205-24-39	24	39,06	133	42,0	3500	77	2,10
P205-12-64	12	64	145,5	42,0	6000	41,5	4,80
P205-24-64	24	64	145,5	42,0	6000	45	2,40
P205-12-100	12	100	145,5	42,0	7000	30,3	3,60
P205-24-100	24	100	145,5	42,0	7000	32,4	1,75
P205-12-156	12	156,25	145,5	42,0	8000	21,3	2,85

Partnumber	Voltage (V)	Reduction (:1)	Length (mm)	Diameter (mm)	Nominal torque (mNm)	Speed at nominal torque	Current (A)
P205-24-156	24	156,25	145,5	42,0	8000	22	1,45
P205-12-244	12	244,14	145,5	42,0	9000	14,9	2,20
P205-24-244	24	244,14	145,5	42,0	9000	14,9	1,10
P205-12-400	12	400	158	42,0	9000	9,4	1,65
P205-24-400	24	400	158	42,0	9000	9,4	0,85
P205-12-625	12	625	158	42,0	9000	6,3	1,25
P205-24-625	24	625	158	42,0	9000	6,3	0,65

Mechanical Dimensions

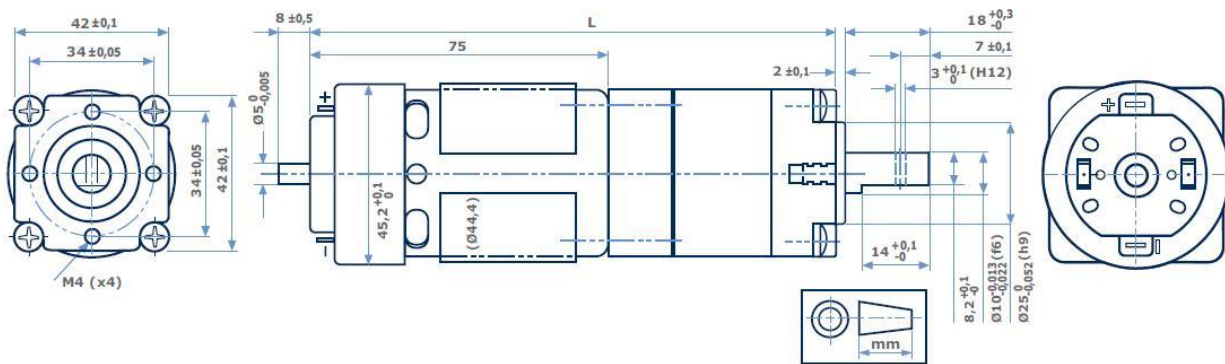

The resistance can be chosen with respect to the required torque and supplied voltage

- Planetary gear-motor
- Motor interference suppression by VDR
- Outgoing shaft supported by two ball bearings
- Maximum radial shaft load: 300N (10 mm from the fixing flange)
- Maximum axial shaft load: 150N
- Direction of rotation depending on polarity
- Can be mounted in any position
- Working temperature range: -20°C/60°C
- Approx weight: 700/900g