

## 35S Series

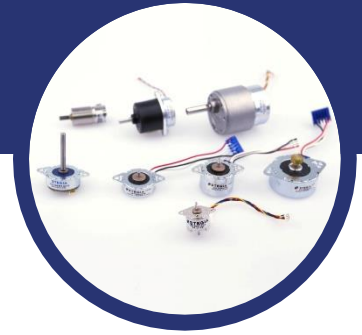

### Key Features

- High torque
- Low noise
- Small size

### General Specifications

Series	Step angle (°)	Voltage (V)	Current (A)	Resistance (Ω)	Inductance (mH)	Holding torque (mNm)	Detent torque (mNm)
<b>35S24B0700</b>	15°	24	0,5	7,5	7,3	38	5,0
<b>35S24B2500</b>	15°	24	0,5	25	22,3	60	5,0
<b>35S48B0700</b>	7,5°	24	0,5	7,5	10	50	7,0
<b>35S48B2500</b>	7,5°	24	0,5	25	27,2	80	8,0
<b>35S96B0700</b>	3,75°	24	0,5	7,5	11,9	35	4,5
<b>35S96B2500</b>	3,75°	24	0,5	25	37	45	4,5

### Optional Features

#### Mechanical Dimensions

- Gearbox
- Custom winding, wire harness
- Custom pinion, leadscrew
- Custom shaft
- Other specifications

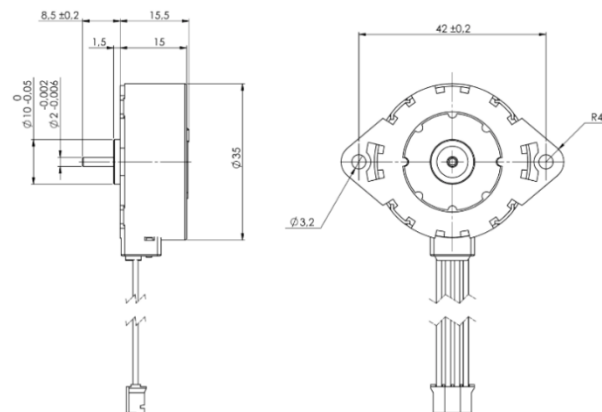

#### Stegia AB

Regattagatan 22B  
723 48 Västerås, Sweden  
+46 (0) 21 811 822  
info@stegia.com

#### Stegia Shanghai Co., Ltd.

A-7, No.38, Dongsheng Rd  
Pudong, Shanghai, China, 201201  
+86 21 58591682

## Dynamic Torque Curves

### 35S24B0700

Conditions: Bi-polar Constant Current Driver  
 Driver: AMIS 30522  
 Mode: Full Step

— Pull in torque    — Pull out torque

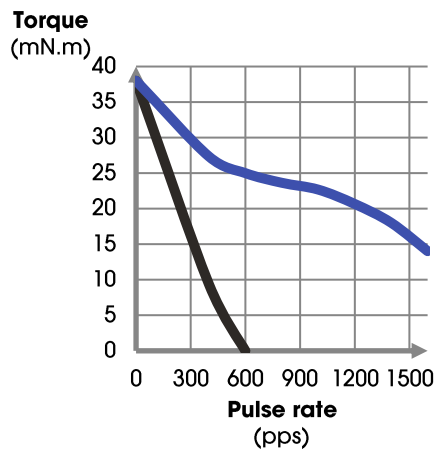

### 35S24B2500

Conditions: Bi-polar Constant Current Driver  
 Driver: AMIS 30522  
 Mode: Full Step

— Pull in torque    — Pull out torque

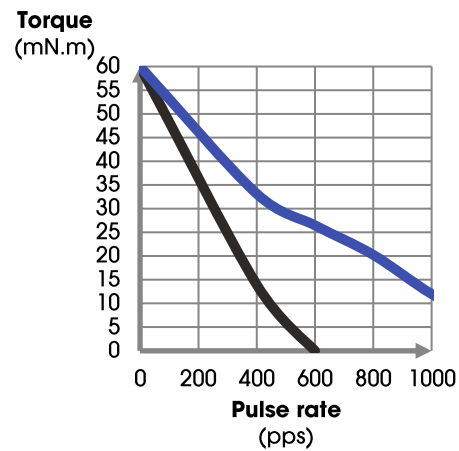

### 35S48B0700

Conditions: Bi-polar Constant Current Driver  
 Driver: AMIS 30522  
 Mode: Full Step

### 35S48B2500

Conditions: Bi-polar Constant Current Driver  
 Driver: AMIS 30522  
 Mode: Full Step

— Pull in torque — Pull out torque

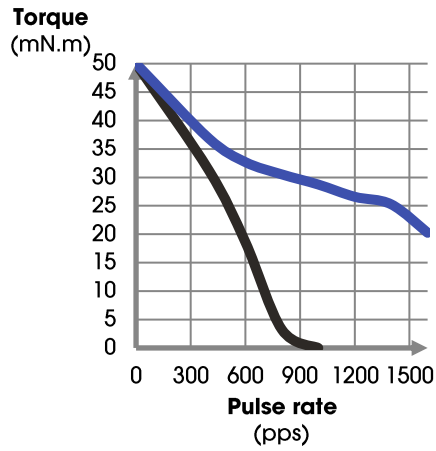

— Pull in torque — Pull out torque

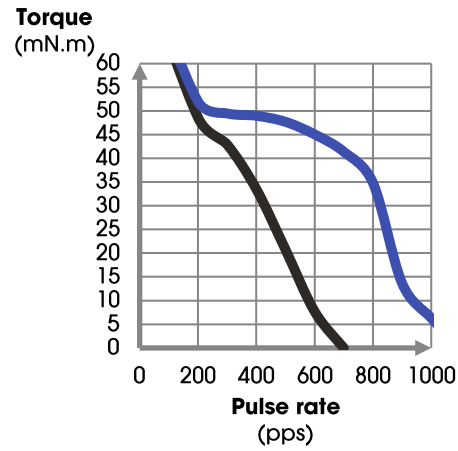

## Dynamic Torque Curves

### 35S96B0700

Conditions: Bi-polar Constant Current Driver  
 Driver: AMIS 30522  
 Mode: Full Step

### 35S96B2500

Conditions: Bi-polar Constant Current Driver  
 Driver: AMIS 30522  
 Mode: Full Step

— Pull in torque — Pull out torque

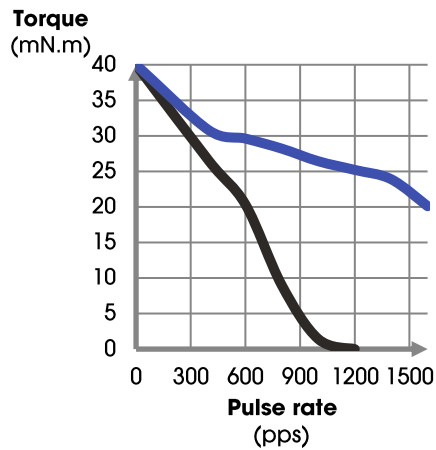

— Pull in torque — Pull out torque

