

## LM25L Series



### Key Features

- Captive, high force
- Low noise, small size
- Pitch 0.5mm & 1.0mm

### General Specifications

Series	Step angle (°)	Voltage (V)	Current (A)	Resistance (ohm)	Inductance (mH)	Increment (mm/step)
LM25L100CB0900	15°	24	0,5	9	6,7	0,0416
LM25L100CB2500	15°	24	0,5	25	17,6	0,0416
LM25L101CB0900	7,5°	24	0,5	9	8,7	0,0208
LM25L101CB2500	7,5°	24	0,5	25	21,3	0,0208
LM25L051CB0900	15°	24	0,5	9	6,7	0,0208
LM25L051CB2500	15°	24	0,5	25	17,6	0,0208
LM25L050CB0900	7,5°	24	0,5	9	8,7	0,0104
LM25L050CB2500	7,5°	24	0,5	25	21,3	0,0104

### Optional Features

- Custom winding, wire harness
- Custom leadscrew
- Drive electronics
- Other specifications

### Mechanical Dimensions

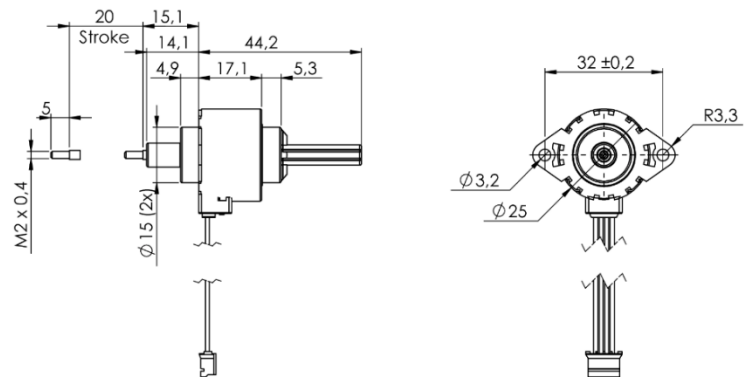

## Dynamic Force Curves

### LM25L100CB0900

Conditions: Bi-polar Constant Current Driver  
 Driver: AMIS 30522  
 Mode: Full Step

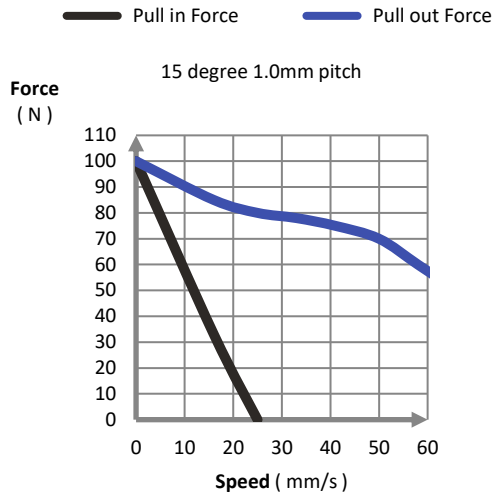

### LM25L100CB2500

Conditions: Bi-polar Constant Current Driver  
 Driver: AMIS 30522  
 Mode: Full Step

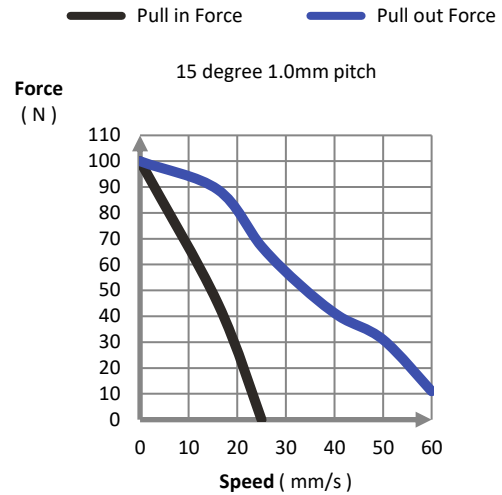

### LM25L051CB0900

Conditions: Bi-polar Constant Current Driver  
 Driver: AMIS 30522  
 Mode: Full Step

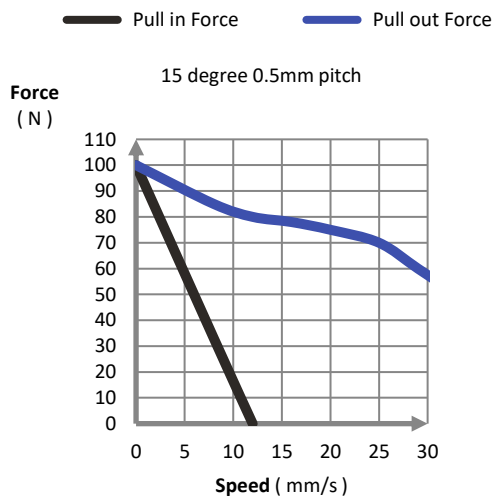

### LM25L051CB2500

Conditions: Bi-polar Constant Current Driver  
 Driver: AMIS 30522  
 Mode: Full Step

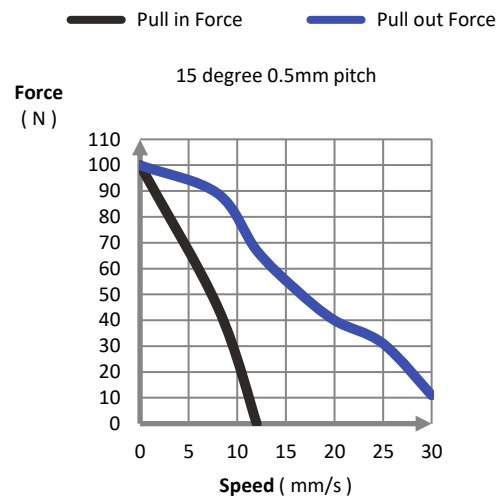

## LM25L101CB0900

Conditions: Bi-polar Constant Current Driver  
 Driver: AMIS 30522  
 Mode: Full Step

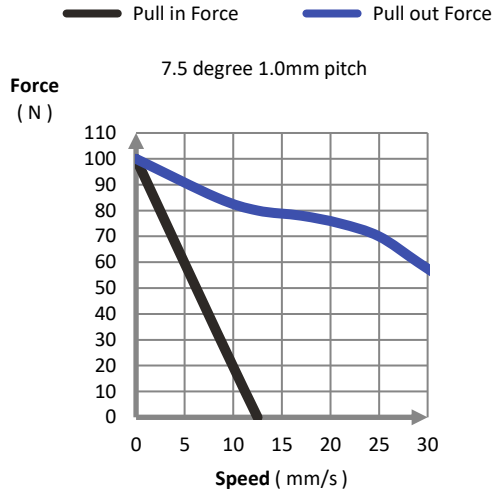

## LM25L101CB2500

Conditions: Bi-polar Constant Current Driver  
 Driver: AMIS 30522  
 Mode: Full Step

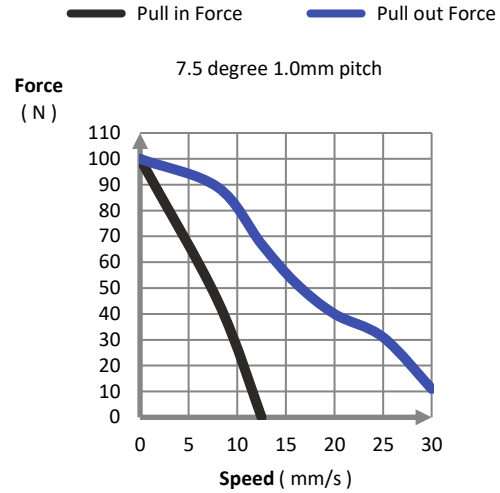

## LM25L050CB0900

Conditions: Bi-polar Constant Current Driver  
 Driver: AMIS 30522  
 Mode: Full Step

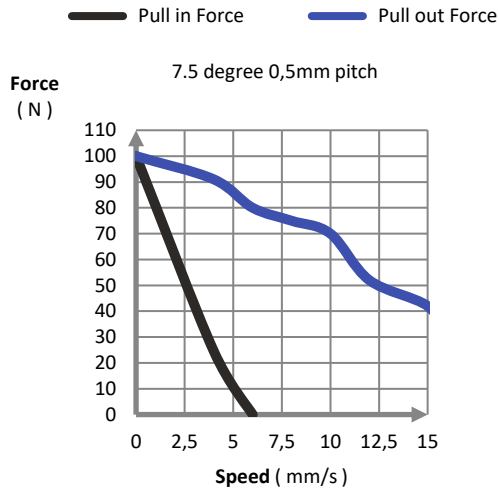

## LM25L050CB2500

Conditions: Bi-polar Constant Current Driver  
 Driver: AMIS 30522  
 Mode: Full Step

