

Motor Specifications

Frame 42mm

| | Unit | Type | | |
|------------------------|-------------------|---|------------|------------|
| | | AM42BL30L2 | AM42BL60L2 | AM42BL90L2 |
| Length | mm | 46 | 70 | 100 |
| Input Voltage | VDC | 24 | 24 | 24 |
| Rated Power | W | 30 | 60 | 90 |
| Phases | | 3 | | |
| Rated Speed | RPM | 4000 | | |
| Max. Speed | RPM | 5000 | | |
| Rated Torque | Nm | 0.072 | 0.144 | 0.215 |
| Peak Torque | Nm | 0.144 | 0.288 | 0.43 |
| Rated Current | Arms | 1.67 | 3.28 | 4.92 |
| Peak Current | Arms | 3.34 | 6.56 | 9.84 |
| Voltage Constant | Vrms/Krpm | 2.95 | 3.00 | 3.00 |
| Torque Constant | Nm/Arms | 0.043 | 0.044 | 0.044 |
| Inertia | g.cm ² | 39 | 72 | 114 |
| Resistance ± 10%(25°C) | Ω | 1.34 | 0.68 | 0.40 |
| Inductance | mH | 1.15 | 0.60 | 0.37 |
| Sensor | | HALL | | |
| Insulation class | | E | | |
| Protective Rating | | IP40 | | |
| Storage Temperature | | -25~+70°C | | |
| Operating Temperature | | 0~+50°C | | |
| Operating Humidity | | 85% RH or below (noncondensing) | | |
| Operating Environment | | Indoors, away from direct sunlight, corrosive gas and flammable gas | | |
| Altitude | | 1000m or below | | |

Dimensions (Unit: mm)

| Series | Length |
|----------|--------|
| | mm |
| AM42BL30 | 46 |
| AM42BL60 | 70 |
| AM42BL90 | 100 |

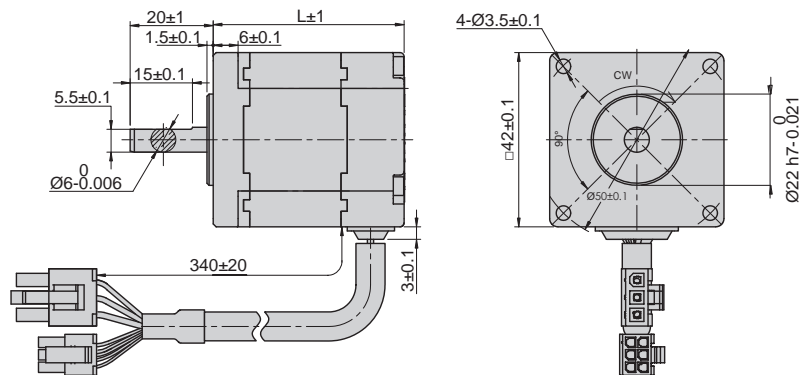

Torque Curves

